

SITUATED IN THE CITY OF GREEN  
 COUNTY OF SUMMIT, STATE OF OHIO,  
 AND KNOWN AS BEING PART OF S.W.  
 QUARTER SECTION 9 AND PART OF  
 N.W. QUARTER SECTION 16 OF  
 FORMER GREEN TOWNSHIP

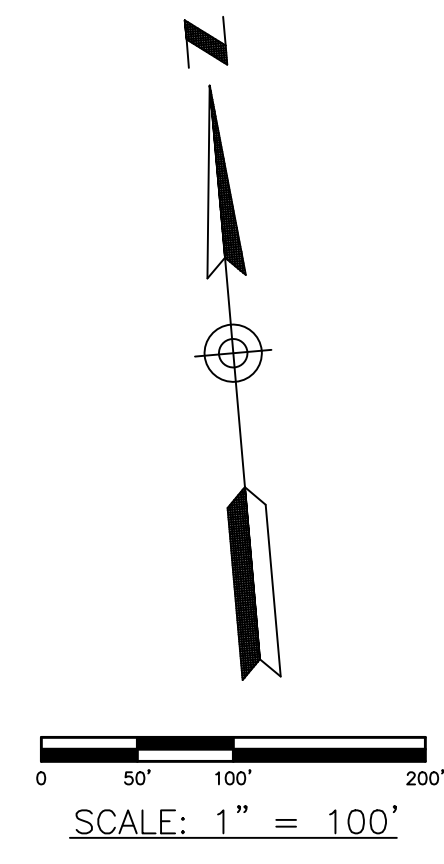

**LEGEND**

PROPOSED RE-ZONING

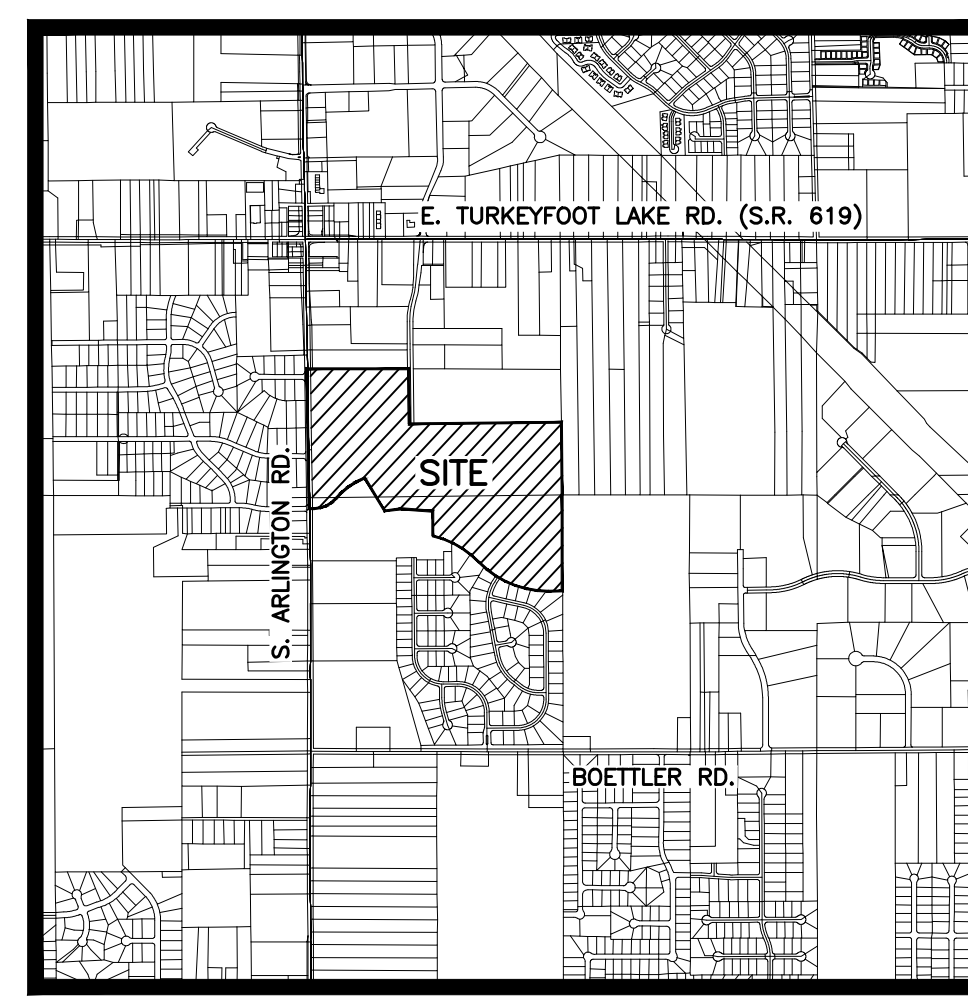

LOCATION MAP

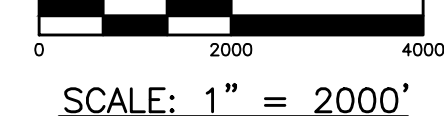

RUSSELL D. & DORLA R. WHITE  
 P.P.N. 2804656

EXISTING  
 R-1 ZONING

ALLIANCE PETROLEUM CORP.  
 P.P.N. 2809631

**GBC DESIGN, INC.**  
 565 White Road Dr.  
 Akron, OH 44320  
 Phone 330-596-0238  
 Fax 330-596-5782

**GREEN LAND TRUST, LTD.**  
 821 S. MAIN ST.  
 NORTH CANTON, OH 44720

SPRING HILL  
 CITY OF GREEN  
 COUNTY, OHIO  
 2021 MASTER PLAN-B

DRAWN BY:  
 D.R.L.

DATE:  
 06/29/2021

PROJECT NO.  
 32099CY

DRAWING NO.  
 1 OF 1

AERIAL PHOTOGRAPHY TAKEN FROM OHIO  
 GEOGRAPHICALLY REFERENCED  
 INFORMATION PROGRAM (OGRIIP). DATED  
 2017.

WETLAND DELINEATION TAKEN FROM  
 PRELIMINARY JURISDICTIONAL WATERS  
 DETERMINATION MAP PREPARED BY CIVIL  
 & ENVIRONMENTAL CONSULTANTS, INC.,  
 DATED 6/14/16.



BINGO ESTATES  
 P.B. 122, P. 61-62

EDWARD C. & CERALDINE  
 V. HUDAK  
 P.P.N. 2804296  
 REC. #55235425

MATTHEW P. DOBRINS  
 P.P.N. 2806896  
 REC. #55235425

ARLINGTON KNOLLS ALLOTMENT  
 P.B. 45, P. 3-4

ROBERT J. &  
 MELISSA A. KERES  
 P.P.N. 2801777  
 REC. #55583378

JOSEPH A. DEROSE  
 P.P.N. 2801776  
 O.R. 1336, P. 1

JOEY A. & PATRICIA A. DENNIS  
 P.P.N. 2809928  
 O.R. 673, P. 414

HIGH STREET CHRISTIAN CHURCH INC.  
 P.P.N. 2815828  
 REC. #55814954

SPRING HILL PHASE THREE  
 REC. #55775424

SPRING HILL PHASE FOUR  
 REC. #55775425